

**CITY OF LOWELL**

---

**PETITION**

**CITY COUNCIL**

**Gas Mains**

*William D. Smith*

William D. Smith

*715 Main St Lowell  
Please to leave 585 St 13 inch gas  
then gas main in middle of*

In City-Council

*July 27, 2021*

Read and hearing ordered for 7PM on

*August 17, 2021*

**Read, Hearing Held,  
Referred to Wire In-  
spector, Development  
Services**

---

City Clerk

## Review of Utility Company Request for New Conduit/Pole Location

Applicant Information

Project Address

Utility  
(Select one) Gas

1895-1939 Middlesex St

Reason National Grid is requesting to relay a gas main on Middlesex St in the in the sidewalk on the north side of Middlesex St. There are utility conflicts in the roadway necessitating the installation in the sidewalk.

Date Submitted 7/22/2021

Review done by Joseph Cady

Sidewalk Material Other

**Note: Sidewalk material to be replaced in kind (Concrete in full panels only)**

Are Sidewalk Vaults present? YES  NO

Is Work on Street under a Paving Moratorium? YES  NO

Is this location within the Flood Plain? YES  NO

Are ADA requirements being met? YES  NO

Comments

Asphalt and concrete sidewalks in work area.

Outcome of Review

Approved

Approved With  
Comments

Denied

Ting Chang, P.E.  
City Engineer

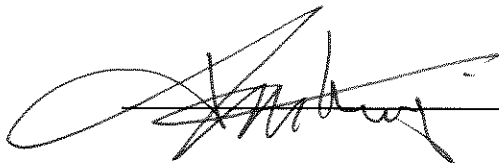

---

National Grid Contact  
Jeffrey LoConte, Lead Supervisor - Contractor Oversight  
[jeffrey.loconte@nationalgrid.com](mailto:jeffrey.loconte@nationalgrid.com)  
Cell # 617-438-8417

Petition of:

National Grid  
775 Dutton St.  
Lowell, MA 01854

For the request to relay 585 feet of 12 inch cast iron gas main located in the shoulder of the public way with a 12 inch plastic gas main in the sidewalk on Middlesex St, Lowell from #1895 Middlesex St to #1939 Middlesex St. Per recommendation of the City Engineering Office and the Lowell Inspector, it is desired that the new gas main be installed in the sidewalk rather than the roadway due to conflicts or close proximity with existing utilities.

TO: Lowell City Clerks Office.

Respectfully represents the NATIONAL GRID of 775 Dutton Street, Lowell, Massachusetts, that it desires to replace our existing 12 inch low pressure cast iron gas main on *Middlesex St*. The proposed installation will replace 585 feet the existing 12 inch gas main with new 12 inch plastic gas main meeting National Grid's latest safety standards. The new gas main will be located in the sidewalk between HSE # 1895 and HSE #1939.

Wherefore it prays that after due notice and hearing as provided by law, it be granted permission to excavate the sidewalk to be located substantially in accordance with the attached plan named "1815 - 1990 MIDDLESEX RD, LOWELL."

NATIONAL GRID

BY   
Lead Supervisor - Contractor Oversight

July 22, 2021

ORDERED:

Notice having been given and public hearing held, as provided by law, that National Grid be and it is hereby granted permission to excavate the sidewalk to install the new gas main in the plan named '1815 – 1990 MIDDLESEX RD, LOWELL" in the sidewalk hereinafter named as said Company may deem necessary, in public way or ways hereinafter referred to, as requested in petition with the said COMPANY dated, July 22, 2021.

Said gas main shall be located substantially in accordance with the attached plan named - "1815-1990 MIDDLESEX RD, LOWELL."

The following are public ways along which the gas main above referred to may be installed: the sidewalk on Middlesex St between HSE #1895 and HSE # 1939 on City Property, Lowell, Ma.

I hereby certify that the foregoing order was adopted at a meeting of the .....  
.....  
....., held on the ..... day of.....,20.....  
....., ..... 20.....

Received and entered in the records of location orders of the City of Lowell, Ma.

Book.....Page.....

Attest:

.....hereby certify that on .....20....., at ..... o'clock,..... M  
At....., a public hearing was held on the petition of  
NATIONAL GRID for permission to install new 12 inch gas main as described in the order  
herewith recorded, and that I mailed at least seven days before said hearing a written notice of  
the time and hearing to each of the owners of real estate (as determined by the last preceding  
assessment for taxation) along the ways or parts of ways upon which the Company is permitted  
to install gas main under said order. And that thereupon said order was duly adopted.

.....  
.....  
.....

- PRESSURE GAUGES ARE REQUIRED AT ALL MAINS FOR ALL TIE-INS. REFER TO GCON-02001 PROCEDURE.
- CHECK ELECTRONIC MAPPING SYSTEM FOR MOST CURRENT MAPPING INFORMATION.

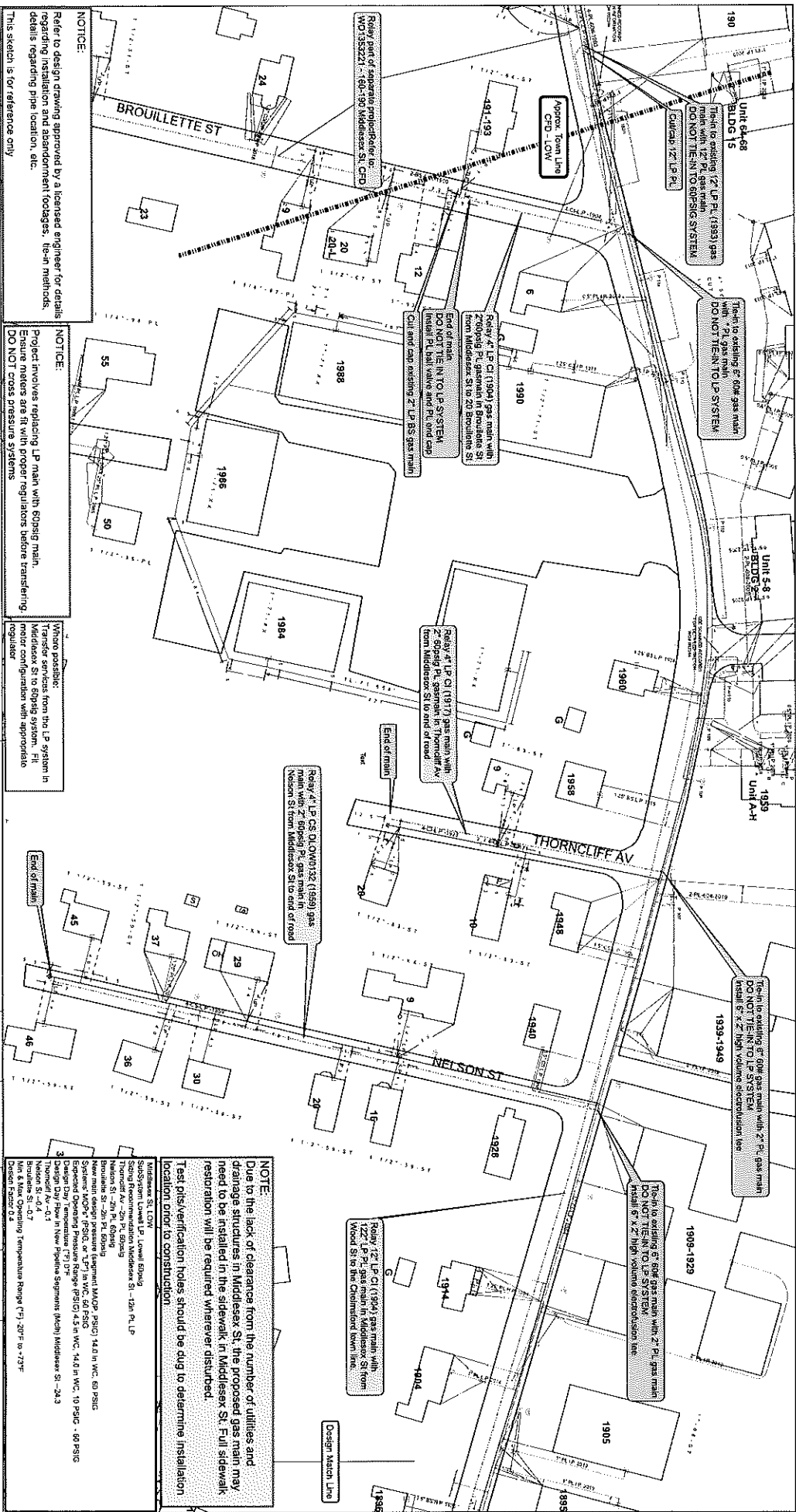

**NOTICE:**  
Refer to design drawing approved by a licensed engineer for details regarding installation and abandonment footings, tie-in methods, details regarding pipe location, etc.

**NOTICE:**  
Project involves replacing LP main with 60psig main. Ensure meters are fit with proper regulators before transferring. DO NOT cross pressure systems.

**NOTICE:**  
Where possible: Transfer services from the LP system in Middlesex St to 60psig system. Fit prior configuration with appropriate regulator.

**ENGINEERING DESIGN - Proposed Scope of Work**

1815-1990 Middlesex St, LOW

Due to roadway reconstruction & paving by the City of Lowell, F72122 PAVING/SEMI recommends the relay of approximately:  
 - 2.250' of 12" LP CI (1994) gas main with 2.250' of 12" LP PL gas main in Middlesex St from Wood St to the Chelmsford town line.  
 - 485' of 4" LP CS DI (1994) gas main with 485' of 2" 60psig PL gas main in Nelson St from Middlesex St to end of road.  
 - 240' of 4" LP CI (1917) gas main with 240' of 2" 60psig PL gas main in Thorncliff Av from Middlesex St to end of road.  
 - 150' of 4" LP CI (1904) gas main with 150' of 2" 60psig PL gas main in Brouillette St from Middlesex St to 20 Brouillette St

DATE: 3/23/21  
 DESIGNER: Adamson, J/T  
 CHECKER: Conner, S  
 SERVICE: 23

|              |              |                  |     |
|--------------|--------------|------------------|-----|
| ENGINEER     | M. Hilbunner | SIZE             | 12" |
| CONTACT      | 781-227-0621 | INSTALL MATERIAL | PL  |
| DATE         | 1/26/2021    | PRESSURE         | LOW |
| WORK ORDER # | 1386458      |                  |     |

**nationalgrid**  
 ArcFM SKETCH

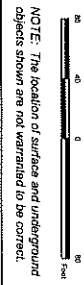

**NOTE:** The location of surface and underground objects shown are not warranted to be correct.

**NOTE:**  
 Due to the lack of clearance from the number of utilities and drainage structures in Middlesex St, the proposed gas main may need to be installed in the sidewalk in Middlesex St. Full sidewalk restoration will be required wherever disturbed.  
 Test pits/verification holes should be dug to determine installation location prior to construction.

**Middlesex St, LOW**  
 Subsystem: Lowell LP, Lowell 60psig  
 Existing Recommendation: Middlesex St - 12in PL LP  
 Thorncliff Av - 2in PL 60psig  
 Brouillette St - 2in PL 60psig  
 New main design pressure (segment): 14.0 in WC, 69 PSIG  
 System: WOPR, F85G, or T87 in WC, 69 PSIG  
 Design Day Temperature: 73°F  
 Design Day Flow in New Pipeline Segment (each): Middlesex St - 24.3  
 Thorncliff Av - 4.1  
 Brouillette St - 0.7  
 Min & Max Operating Temperature Range: 73°F to 73°F  
 Meter: Meter 0.2

- PRESSURE GAUGES ARE REQUIRED AT ALL MAINS FOR ALL TIE-INS. REFER TO GCON-02001 PROCEDURE.
- CHECK ELECTRONIC MAPPING SYSTEM FOR MOST CURRENT MAPPING INFORMATION.

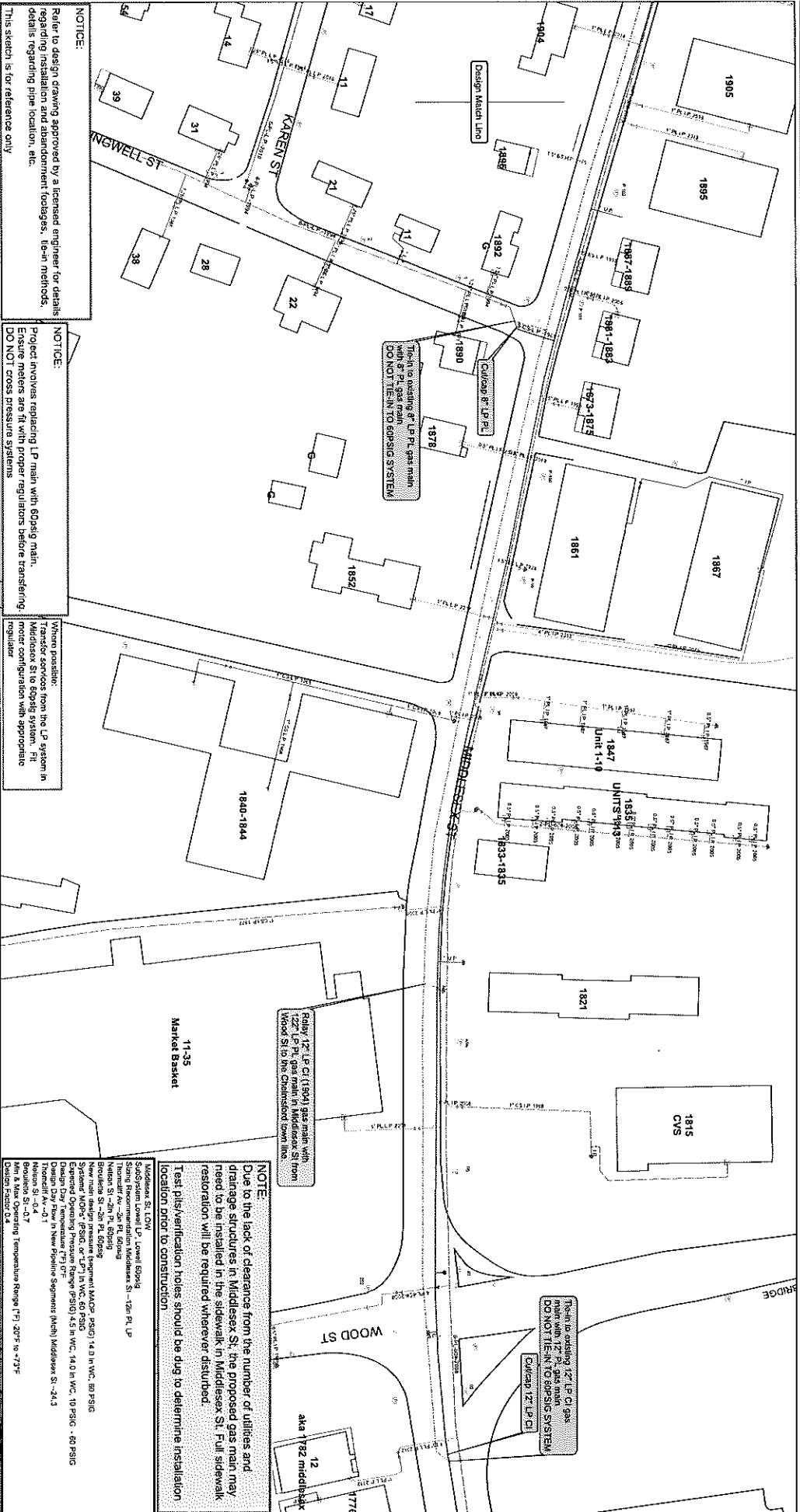

**NOTICE:**  
Refer to design drawing approved by a licensed engineer for details regarding installation and abandonment (buddies, tie-in methods, details regarding pipe location, etc.

**NOTICE:**  
Project involves replacing LP main with 60psig main. Existing meters are fit with proper regulators before transferring LONI cross pressure systems.

**NOTICE:**  
When possible, transfer services from the LP system in Middlesex St to existing system. Fit meter configuration with appropriate regulator.

**ENGINEERING DESIGN - Proposed Scope of Work**  
**1815-1990 Middlesex St, LOW**

Due to roadway reconstruction & paving by the City of Lowell, FV2/22 PAVONONREIN recommends the relay of approximately:  
 - 2.250' of 12" LP CI (1904) gas main with 2.250' of 12" LP PL gas main in Middlesex St from Wood St to the Chelmsford town line.  
 - 4.85' of 4" LP CS (1904) gas main with 4.85' of 2" 60psig PL gas main in Middlesex St from Middlesex St to end of road.  
 - 2.00' of 4" LP CI (1917) gas main with 2.00' of 2" 60psig PL gas main in Middlesex St from Middlesex St to end of road.  
 - 150' of 4" LP CI (1904) gas main with 150' of 2" 60psig PL gas main in Middlesex St from Middlesex St to 20 Brattle St.

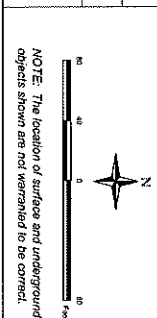

| ENGINEER     | SIZE             |
|--------------|------------------|
| M. Hildner   | 12"              |
| CONTRACT     | INSTALL MATERIAL |
| 781-227-0621 | PL               |
| DATE         | PRESSURE         |
| 1/26/2021    | LOW              |
| WORK ORDER # |                  |
| 1386458      |                  |

**nationalgrid**  
ARCHM SKETCH

11-35  
Market Basket

Roller 12" LP CI (1904) gas main with 122' LP PL gas main in Middlesex St from Wood St to the Chelmsford town line.

Roller 12" LP CI gas main with 1782' middlesex St

Roller 12" LP CI gas main with 1782' middlesex St

**NOTE:**  
Due to the lack of clearance from the number of utilities and drainage structures in Middlesex St, the proposed gas main may need to be installed in the sidewalk in Middlesex St. Full sidewalk restoration will be required wherever disturbed.  
Test pits/verification holes should be dug to determine installation location prior to construction.

**Middlesex St, LOW**  
Substation Lowell LP, Lowell 60psig  
Selling Recommendation Middlesex St - 12" LP PL  
New main design pressure (segment MAOP - psig) 14.0 in WC, 80 psig  
System MAOP (psig) or (LP) in WC, 60 psig  
Design Day Temperature (°F) 75°F  
Design Day Flow in New Pipeline Segment (Mcf) Middlesex St - 24.3  
Proposed Av. - 0.1  
Proposed Max. - 0.7  
Min. & Max. Operating Temperature Range (°F) 20°F to -72°F  
Weather Factor 0.4

